



The Rainier | 3,213 SF | 4-5 Bedroom | 2.5-3.5 Bath



Spacious floor plan allows for the flexibility to make the home perfect for you.

- Spacious master suite features a soaking tub, large shower, and walk in closet on main floor.
- The kitchen is open to the great room and flows into dining room through a butler's pantry, creating a great place for gatherings and holidays.
- Upstairs laundry room keeps the downstairs neat and tidy.
- Two story great room creates a picture perfect place to relax and unwind.



GarretteCustomHomes.com



OR PLH and GCH CCB# 173524; WA LIC # PACIFLH924RI; WA GCH LIC# GARRECH915MA In an effort to continuously improve our product; PLH reserves the right to modify pricing, plans, policies, exteriors, and specification. These are computer renderings and actual construction may vary. Square footage is approximate. Floor plan and finishes may vary from one neighborhood to another. R 6/19



The Rainier | 3,213 SF | 4-5 Bedroom | 2.5-3.5 Bath



Jack-N-Jill Option

Optional Jack and Jill
bathroom

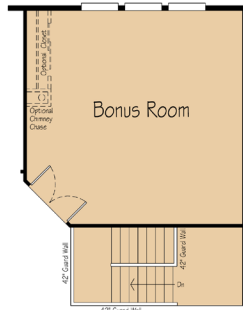

Optional Bonus
Room

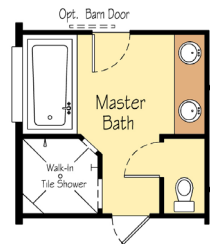

Custom Shaped
Shower Option

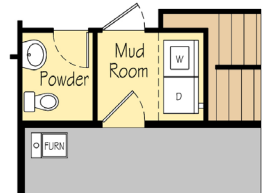

Main Floor
Laundry Option



GarretteCustomHomes.com

